

Intersection of West Line of Block 5, PLUNKETT'S SUB. & South R/W Line of CANTRELL ROAD

CANTRELL ROAD - AR. STATE HWY #10.
 D = S 51° 17' 45" E 1015' W = S 51° 17' 45" E 1015' W
 D = S 51° 17' 45" E 1015' W = S 51° 17' 45" E 1015' W
 CANTRELL ROAD - AR. STATE HWY #10.

D = S 25° 26' 50" E 20.43' S
 M = S 25° 25' 03" E 20.47' S
 Spike E.

L.R.E.

D = N 00° 46' 40" W 169.34' M = N 00° 20' 47" W 164.33'

EAST 1/2 FLORIDA ST. (CLOSED)

NORTH 1/2 OHIO ST. (CLOSED)

D = S 89° 46' 50" W 99.61' M = N 89° 53' 29" W 98.74'

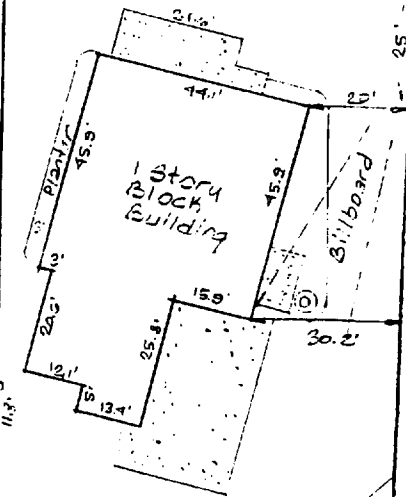

DEED N 01° 22' 50" W 135.12' MEAS. N 02° 52' 22" W 151.07'

MEAS. S 01° 12' 21" W 25.47'

FIRE STATION

DEED S 01° 20' 30" E 45.95'

SURVEY CERTIFICATE

I hereby certify that this survey made under my supervision on March 19, 2009, and is my opinion of the property lines of land indicated hereon. There are no encroachments or overlaps onto adjoining property of property covered by this survey or buildings or structures located on said land or encroachment of

LEGAL DESCRIPTION

All that part of the W 1/2 W 1/2, Block 5, PLUNKETT'S SUBDIVISION of Forest Park, Madison County, Arkansas, lying South of Cantrell Road.